

Schematic #23

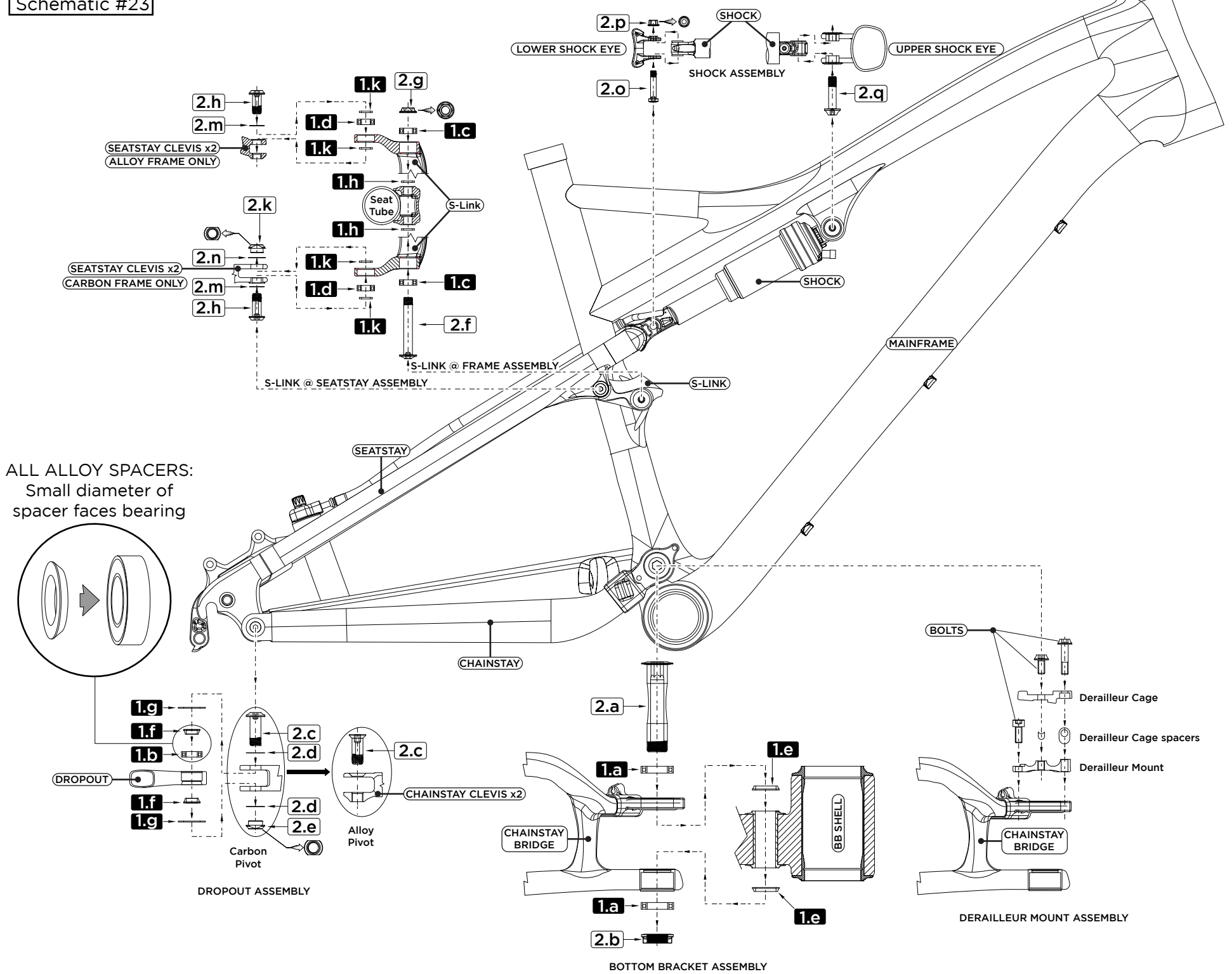

2009 - 2010 Epic 26" / 29er
2009-2010 Era FSR

9899-5080

Part#	Qty	Part Description	Part Specification
1.a	2	BB Bearing	1524F Full Complement Bearing - 24mm O.D. x 15mm I.D. x 5mm Thick
1.b	2	Dropout Bearing	6800V-2RS Full Complement Bearing - 19mm O.D. x 10mm I.D. x 5mm Thick
1.c	2	S- Link @ Frame Bearing	688 Series Bearing - 16mm O.D. x 8mm I.D. x 5mm Thick
1.d	2	S- Link @ Seatstay Bearing	688 Series Bearing - 16mm O.D. x 8mm I.D. x 5mm Thick
1.e	2	BB Spacer	Alloy Spacer - 20mm O.D. x 15mm I.D. x 3mm Thick, Chamfered
1.f	4	Dropout Bearing Spacer	Alloy Spacer - 15mm O.D. x 10mm I.D. x 4.5mm Thick, Chamfered
1.g	4	Dropout Teflon Thrust Spacer	Teflon Washer - 22mm O.D. x 15mm I.D. x 0.85mm Thick
1.h	2	S-Link @ Frame Spacer	Alloy Spacer - 12mm O.D. x 8mm I.D. x 1.4mm Thick, Chamfered
1.k	4	S-Link @ Seatstay Spacer	Alloy Spacer - 12mm O.D. x 8mm I.D. x 1.4mm Thick, Chamfered

9899-5180

B = Blue Loctite required

Part#	Qty	Part Description	Part Specification	Torque in*lb
2.a	1	BB Axle	Alloy Axle - M14 Thread (23.5mm Head O.D.) x 64.5mm Shaft Length, 8mm Hex	200-230 B
2.b	2	BB Nut	Alloy Nut - M14 Thread x 23.5mm O.D., 17mm Socket (use 6-point socket only)	
2.c	2	Dropout Bolt (Alloy Frame)	Alloy Bolt - M10 Thread x 23.6mm Shaft Length, 4mm Hex, Countersunk Head	120-140 B
2.c	2	Dropout Bolt (Carbon Frame)	Alloy Bolt - M10 Thread x 26.5mm Shaft Length, 4mm Hex	120-140 B
2.d	2	Dropout Washer (Carbon Frame)	Steel Washer - 17mm O.D. x 13mm I.D. x 0.3mm Thick	
2.e	2	Dropout Nut (Carbon Frame)	Alloy Nut - M10 Thread x 17mm O.D. x 7.6mm Thick, 13mm Open Wrench	
2.f	1	S- Link @ Frame Bolt	Alloy Axle - M8 Thread x 52.5mm Shaft Length, 4mm Hex	70-90 B
2.g	1	S-Link @ Frame Nut	Alloy Nut - M8 Thread x 15.7mm O.D., 11mm socket (use 6-point socket only)	
2.h	4	S- Link @ Seatstay Bolt (Alloy frame)	Alloy Bolt - M8 Thread x 18mm Shaft Length, 4mm Hex	70-90 B
2.h	2	S- Link @ Seatstay Bolt (Carbon frame)	Alloy Bolt - M8 Thread x 21mm Shaft Length, 4mm Hex	70-90 B
2.k	1	S-Link @ Seatstay Nut (Carbon Frame)	Alloy Nut - M10 Thread x 15.7mm O.D. x 7.6mm Thick, 13mm Open Wrench	
2.m	2	S-Link @ Seatstay Washer (Alloy / Carbon Frame, bolt side)	Steel Washer - 14mm O.D. x 8mm I.D. x 0.3mm Thick	
2.n	1	S-Link @ Seatstay Washer (Carbon Frame, nut side)	Steel Washer - 15mm O.D. x 11.5mm I.D. x 0.3mm Thick	
2.o	1	Lower (Rearward) Shock Eye Bolt	Steel Bolt - M6 Thread x 32.5mm Shaft Length, 4mm Hex	60-70 B
2.p	1	Lower (Rearward) Shock Eye Nut	Alloy Nut - M6 Thread x 12.6mm O.D., 10mm Socket (use 6-point socket only)	70-90 B
2.q	1	Upper (Forward) Shock Eye Bolt (Alloy Frame)	Alloy Bolt - M8 Thread x 34mm Shaft Length, 4mm hex	70-90 B
2.q	1	Upper (Forward) Shock Eye Bolt (Carbon Frame)	Alloy Bolt - M8 Thread x 26.5mm Shaft Length, 4mm hex	70-90 B