

# CS-9000 11-Speed

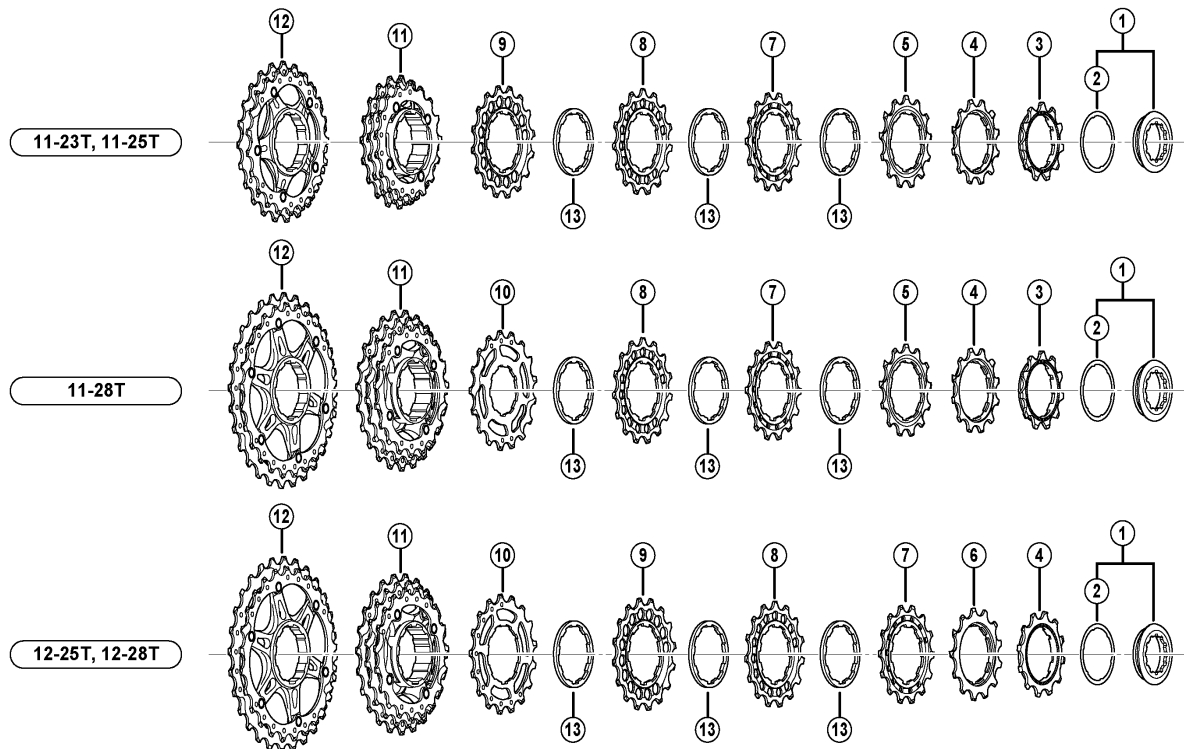

**CS-9000 sprocket teeth combinations**

11 - 23 T	11 - 12 - 13 - 14 - 15 - 16 - <del>17 - 18 - 19</del> - <del>21 - 23</del> T
11 - 25 T	11 - 12 - 13 - 14 - 15 - 16 - <del>17 - 19 - 21</del> - <del>23 - 25</del> T
11 - 28 T	11 - 12 - 13 - 14 - 15 - 17 - <del>19 - 21 - 23</del> - <del>25 - 28</del> T
12 - 25 T	12 - 13 - 14 - 15 - 16 - 17 - <del>18 - 19 - 21</del> - <del>23 - 25</del> T
12 - 28 T	12 - 13 - 14 - 15 - 16 - 17 - <del>19 - 21 - 23</del> - <del>25 - 28</del> T

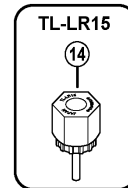

ITEM NO.	SHIMANO CODE NO.	DESCRIPTION
1	Y1YC98010	Lock Ring & Spacer
2	Y10Z04000	Lock Ring Spacer
3	Y1YC11000	Sprocket Wheel 11T (Built in spacer type) for 11-23T, 11-25T, 11-28T
4	Y1YC12000	Sprocket Wheel 12T (Built in spacer type) for 11-23T, 11-25T, 11-28T
	Y1YC12100	Sprocket Wheel 12T (Built in spacer type) for 12-25T, 12-28T
5	Y1YC13000	Sprocket Wheel 13T for 11-23T, 11-25T, 11-28T
6	Y1YC13100	Sprocket Wheel 13T (Built in spacer type) for 12-25T, 12-28T
7	Y1YC14000	Sprocket Wheel 14T
8	Y1YC15000	Sprocket Wheel 15T
9	Y1YC16000	Sprocket Wheel 16T
10	Y1YC17100	Sprocket Wheel 17T for 11-28T
	Y1YC17200	Sprocket Wheel 17T for 12-25T, 12-28T
*	Y1YC98120	Sprocket Unit (17-18-19T) for 11-23T
*	Y1YC98130	Sprocket Unit (17-19-21T) for 11-25T
* 11	Y1YC98140	Sprocket Unit (19-21-23T) for 11-28T
*	Y1YC98150	Sprocket Unit (18-19-21T) for 12-25T
*	Y1YC98160	Sprocket Unit (19-21-23T) for 12-28T
12	Y1YC98070	Sprocket Unit (21-23T) for 11-23T (Sprocket Carrier for 5arm)
	Y1YC98080	Sprocket Unit (23-25T) for 11-25T (Sprocket Carrier for 6arm)
	Y1YC98090	Sprocket Unit (25-28T) for 11-28T (Sprocket Carrier for 6arm)
	Y1YC98100	Sprocket Unit (23-25T) for 12-25T (Sprocket Carrier for 6arm)
	Y1YC98110	Sprocket Unit (25-28T) for 12-28T (Sprocket Carrier for 6arm)
13	Y1YC05000	Sprocket Spacer (t=2.18 mm)
14	Y12009230	Lock Ring Removal Tool (TL-LR15)

A: Same parts.

B: Parts are usable, but differ in materials, appearance, finish, size, etc.

Absence of mark indicates non-interchangeability.

Jan.-2014-3324A

© Shimano Inc. H